

6-in-1 1080P PTZ with 20x /30x optical zoom

H719 Series 6-in-1 Full HD IR High Speed Dome Camera

Features:

- Full HD 1080P resolution, 2.1MP Sony Starvis image sensor;
- 20x/30x optical zoom and 32x digital zoom;
- 6-in-1 design, integrating AHD/TVI/CVI/HD-SDI/EX-SDI /CVBS into one single speed dome camera;
- Easy swapping between Coax HD and IP, simply by replacing the inner box with one hand;
- Simple DIP Switch for switching video signal outputs of AHD/TVI/CVI/HD-SDI/EX-SDI/CVBS;
- Control PTZ camera movement and transmit video over a single coaxial cable(UTC);
- Micro-Stepping technology makes PT motion smoother, especially at maximum optical zoom ratio;
- Compound Movement makes the speed dome reach the preset in the shortest route;
- Full 360° continuous pan rotation for complete area coverage;
- Maximum PT manual speed up to 300°/s, accuracy up to +/-0.01°;
- Support 255 presets, 8 scans, 8 patterns, 8 groups, 16 schedules, 8 privacy masks;
- Auto focus/Auto flip/Auto protocol identification/Power up;
- HLC/BLC/WDR/DIS/Defog;
- True Day&Night
- Innovative easy installation design to free your hands;
- OSRAM IR LED lights enhance sensitivity during night, IR distance up to 150 meters;
- Protection against lightning strikes and power surges;
- Weatherproof for outdoor & indoor installation (IP66 Rated).

Application Scenes:

H719 Series 6-in-1 Full HD IR High Speed Dome Camera could be used in any places where surveillance is required, like hotel, commercial building, plaza, parking lot, revenue, bank, big mall, supermarket, hospital, education organization, residential zone and so on.

Models for order:

H719AD-HA200-5PC6/H719AD-HA200-5PC6:
20x optical zoom with wall mount/pendant mount

H719AD-HB200-5PK6/H719AD-HB200-5PK6:
30x optical zoom with wall mount/pendant mount



IP Version



Coax HD Version

Dimension: (unit: mm)

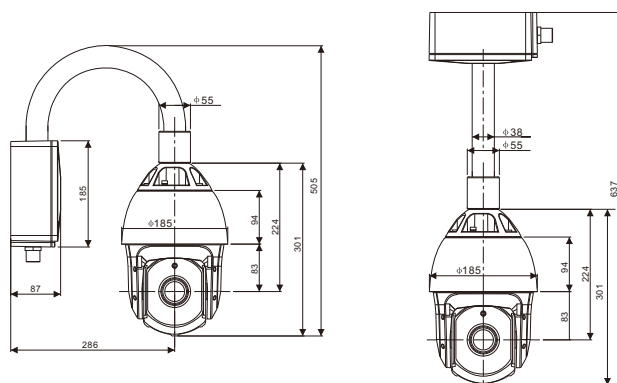

Optional bracket: (unit: mm)

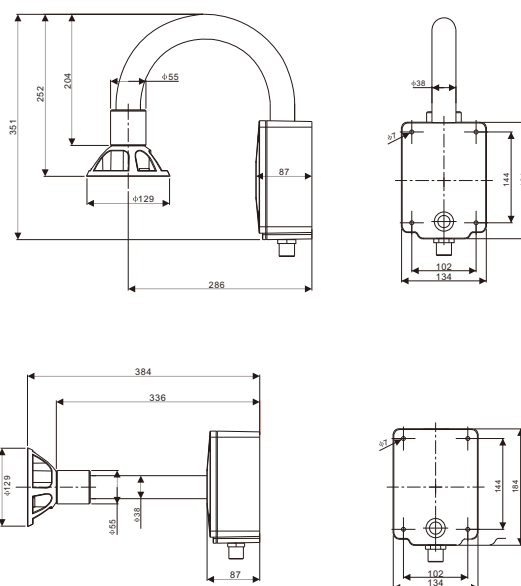

6-in-1 1080P PTZ with 20x /30x optical zoom

Technical Parameters

Model No.		HD-SDI	EX-SDI	HD-CVI	HD-TVI	HD-AHD	Analog
		20x			30x		
Camera	Sensor	1/2.8" Sony Starvis CMOS sensor					
	Resolution	1080P	1080P	1080P	1080P	1080P	700TVL
	Zoom Ratio	20x Optical zoom, 32x digital zoom			30x Optical zoom, 32x digital zoom		
	Focal Length	f=4.7(Wide) – 94(Tele)mm			f=4.3(Wide) – 129(Tele)mm		
	Iris	F=1.6(Wide)-3.5(Tele)			F=1.6(Wide)-5.0(Tele)		
	Mini Illumination	Color:0.2Lux, BW:0.05Lux; Color DSS:0.002Lux,BW DSS:0.001Lux					
	Day/Night	Auto/Day/Night					
	Focus	Manual/Auto / One Push					
	Iris	Auto/Manual					
	Shutter Speed	1/30(25) sec ~ 1/300,000 sec					
	DSS	Auto/Off					
	White Balance	Auto/Indoor/Outdoor/Manual					
	Mirror	None/Horizontal/Vertical/Horizontal& Vertical					
	HLC/WDR/BLC/DIS/Defog	On/Off					
	Privacy Mask	8 privacy masks programmable					
PTZ Function	Pan/Tilt Range	Pan: 360°endless, Tilt: 130°					
	Speed	Max.300 °/sec (proportional to zoom ratio)					
	Preset	Up to 255					
	Auto Scan	8					
	Pattern	8					
	Group	8					
	Schedule	16					
	RS 485	Yes					
	Other PTZ Functions	Auto Flip, Parking Action, Auto protocol identification,Power up Action					
	Alarm In/Out	8CH/4CH					
	Alarm Trigger Event	Alarm out, preset, scan, pattern, group					
	Protocol	Pelco D/P					
	Baud rate	2400/4800/9600 bps					
IR Function	IR radiation distance	Approximately 150m					
	Infrared mode	Auto/ Manual/ Semi-Auto					
	IR LED layout	OSRAM IR LED for Near:2; Middle:2; Far:3; 7 Leds in total.					
	IR LED power	Each max. 2.3W					
	IR LED current	1A					
General	Dimension	Main unit without mount bracket: Φ185mm*288.5mm					
	Net Weight	2.8 Kg(Only PTZ dome without mount bracket)					
	Gross Weight	5.2Kg (with wall mounting bracket)					
	Working Temp.	-30°C ~ +50°C;					
	Working Humidity	90% (Non-condensing)					
	Fan	Yes					
	Power Supply	DC12V /AC 24V					
	Power Consumption	AC24V: 40W Max., DC12V: 36W Max.					
	Service Power Supply Output	DC12V/500mA					
	IP Rating	IP 66					
	Protection Grade	Power 6000V, Video 6000V, RS485 6000V					
	Certificate	CE, FCC					